

# WELD-ON<sup>®</sup>

# ECO<sup>™</sup>

Weld-On ECO為無THF配方設計，減少臭味與VOC以保證施工者的安全。施工者應搖動瓶身以激活配方，避免沉澱並確保最佳的接合性能。

Weld-On ECO is a THF-Free formula designed to keep installers safe by reducing fumes and VOCs. Installers should '**Shake to Activate**' the formula to avoid settling and to ensure maximum bonding performance.

均勻搖動

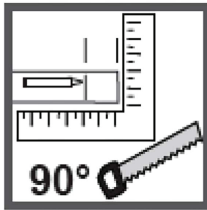

1. 均勻搖動/備好管材

## 1. SHAKE WELL. PREPARE PIPE

**Shake Well if setting occurs.** 如有沈澱現象請均勻搖動。  
**Cut and mark pipe. Chamfer outer diameter 10-22° and deburr.** 切管並做記號，導角10-22度。

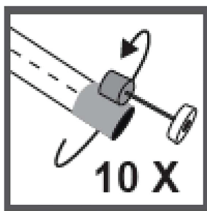
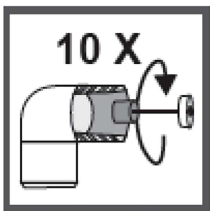

2. PRIME 2. 塗清潔劑

Apply WELD-ON<sup>®</sup> Primer. 塗抹WELD-ON清潔劑

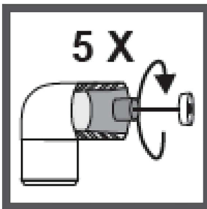
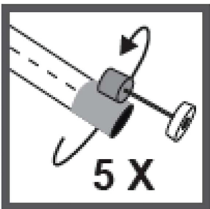

3. APPLY CEMENT 3. 塗膠劑

Apply to pipe 在直管上塗膠劑  
Apply to fitting 在配件上塗膠劑  
Apply again to pipe 再次於直管上塗膠劑

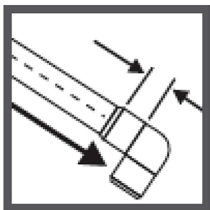

4. ASSEMBLE JOINT 4. 接合

Insert pipe into fitting while wet. Hold for 30sec.  
Wipe off excess cement.  
在膠劑未乾前將直管插入配件，持壓30秒，並擦拭多餘的膠水。

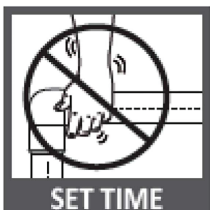

5. SET & CURE JOINT 5. 持壓與乾燥

Do not remove joint. 請勿移動接合處  
Set time 2" pipe = 5 minutes. 2"管件：持壓5分鐘  
Cure time 2" pipe = 1/2 hour @ 60-100F /  
15-28C. Pressure test <160 psi.  
2"管件乾燥時間：半小時（華氏60-100度/攝氏15-28度），試壓小於160psi

Exceeds 1,000 Hour Hydro Pressure Test.